

PART# BBV-2011R



BlendMount®
Innovative Mounting Solutions



INSTALLATION INSTRUCTIONS FOR BLACKVUE DR900S, DR750S, DR650S
DR650GW, DR600GW, DR590, DR490, DR470, DR450, DR430

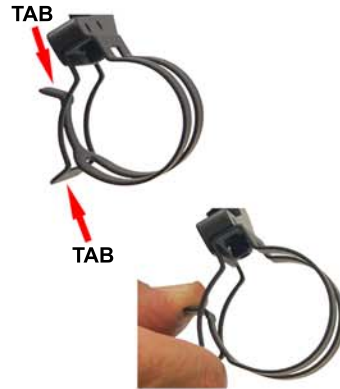

BUSHING STRIPS ARE
USED FOR THE SMALLER
DIAMETER DASHCAMS.
DR590, DR490, DR470,
DR450, AND DR430

1 - To install the dashcam into the mount, simply squeeze the two tabs of the spring clip together as shown above. This will increase the diameter of the spring clip and allow you to slide the dashcam into position. Once the dashcam is in position, release the two tabs. The dashcam is now securely attached to the mount.

2 - Place the 2 bushing strips on the opposite side of the tabs as shown above.

REMOVE
RIGHT TOP
HALF

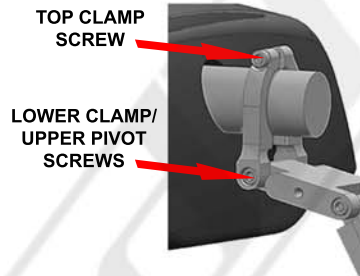

3 - Install the mount while sitting in the passenger side of your vehicle. Remove the right-top half of the mount and position the mount around the mirror stem as shown above. Reattach the right side of the mount. Make sure the lock washer is still on the lower clamp / upper pivot screw. Leave the top clamp screw loose so the mount can slide along the mirror stem and rotate to the desired location. There may be a plastic oval clip around a wire on the stem, the clip must be removed to install the mount.

Lightly snug screws, do not fully tighten until last step.

CENTER LINK



With center
link installed



Without center
link installed

4 - The center-link may be removed if an overall shorter mount length is needed, depending on your rear view mirror and desired position for the dashcam.

FOR MORE INFO VISIT www.blendmount.com/videos

CAUTION

DO NOT use this mount if it interferes with the adjustability or the operation of your rear view mirror in any way.

DO NOT use this mount if the dashcam creates an unsafe viewing obstruction.

DO NOT ATTEMPT TO MODIFY THIS PRODUCT. Consult the manufacturer for assistance.

All BlendMount products are accompanied with detailed installation instructions and adjustment tips. You are encouraged to contact customerservice@blendmount.com or call J28 Design at 1-888-497-8388 for further assistance.

Check the BlendMount Forum for installation tips and some vehicle specific installs.

www.blendmount.com



**Innovative Design And
Precision Manufacturing**

Your feedback is very important to us. Please email any questions or comments you have to customerservice@blendmount.com

BlendMount - US PATENT # D625,580 S, D656,811 S, D653,980 S
D690,245 S, D690,246 S, D690,247 S and other patents pending